

**KEY OF PROPOSED LANDSCAPE WORKS**

**EXISTING FEATURES**

- A Toilets
- B Access driveway
- C Informal car parking
- D Informal canoe launching area
- E Popular fishing area
- F Popular dog swim beach
- G Services - covers (maintain access)
- H Concrete path from car park to toilets
- J Maintenance vehicle access point
- K Bore pump / irrigation controls
- L Flood lights near toilets
- OS Open space area - reticulated turf

**STAGE 1 - RECOMMENDED WORKS 2020-21 (subject to funding)**

- 1 Proposed iron filtration unit and enclosure
- 2 Proposed cement stabilised limestone path to link bridge to existing path (possibly seal in future with universally accessible material) with possible heavy logs along car park side of path to restrict vehicle access (suggest to replace logs in future with bollards)
- 3 Proposed shade shelter with accessible picnic setting
- 4 Proposed link path from toilets to river side path via gazebo to link with River Heritage Trail project (due to be constructed in 2019-20)
- 5 Proposed low square multi-use seating platforms
- 6 Proposed double bin enclosures
- 7 Proposed park welcome signage and possible code of shared use (2 signs near car park in main part of reserve, 1 sign at Scouts end)
- 8 Proposed removal of existing U-bar in path
- 9 Proposed seat adjacent path, near popular dog swim beach
- 10 Proposed renewal / upgrade of reserve lighting, as required
- 11 Make 'dog swim beach' safer by removing submerged rocks
- 12 Proposed new tree planting - suggest *Agonis flexuosa* (WA Peppermint)
- 13 Proposed installation of nesting boxes for native micro-bats (locate on site)
- 14 Retain and refurbish existing memorial seat; suggest relocating in future onto 'future possible new river river platform' (as identified in item 16 below)

**General notes:**







Recommended natural look and feel wherever possible, including timber-look materials and earthy colours  
Proposed retention of stumps and logs for dog play features and for habitat

**FUTURE POSSIBLE WORKS (subject to funding)**

- 15 Possible new 2.5m wide universally accessible path surfacing from bridge to northern extent of reticulated turf
- 16 Possible new river fishing platform - suggest a leaf shaped fixed deck
- 17 Possible renewal of existing gazebo and new accessible ramps
- 18 Possible drink fountain with dog bowl
- 19 Possible additional reserve signage including directional / informational
- 20 Possible upgrade to car parking - recommend natural look 'earth coloured' surfacing (subject to detailed design)
- 21 Possible future parking area for trailers (work around existing trees - retain)
- 22 Possible future mobile trader bay (work around existing trees - retain)
- 23 Possible modification to access driveway entrance and bottom end, to create two vehicle pull-over bays for safer vehicle access and egress
- 24 Possible new maintenance access points, with removable bollards
- 25 Possible future path circuit linking toilets with proposed new river platform
- 26 Possible new vehicle exclusion bollards around car park (e.g. composite material) to replace existing bollards, limestone blocks and temporary logs
- 27 Possible future bicycle parking
- 28 Possible interpretive signage - to tie in with upcoming River Heritage Trail project (2019-20)
- 29 Possible future refurbishment of steps at 'dog swim beach'

Recommend future environmental works including bushland weed removal and river bank erosion mitigation works (subject to funding)  
Possible future security camera - suggest on hinged pole and with sensor light, in most suitable location with view to car park and toilets  
Possible additional dog waste bag dispensers, if required  
Possible opportunities for 'art in the park' - e.g. dog themed / native fauna  
Possible future improvements near the Scout Hall including to the river platform and the access way, plus a new retaining wall adjacent the path

**LEGEND**

-  Existing light posts - recommend renewal / upgrade as required
-  Proposed new local native trees (suggest *Agonis flexuosa* - WA Peppermint) (recommended to be same material as proposed new River Heritage Trail)
-  Proposed new 2m wide concrete path link to match existing
-  Proposed new crushed limestone path to match existing, to link bridge with existing path along reserve (possibly seal in future, see below)
-  Possible future new 2.5m wide sealed red coloured universally accessible pathway (recommended to be same material as proposed new River Heritage Trail)
-  Possible future circuit path link 2m wide
-  Possible new future artwork location

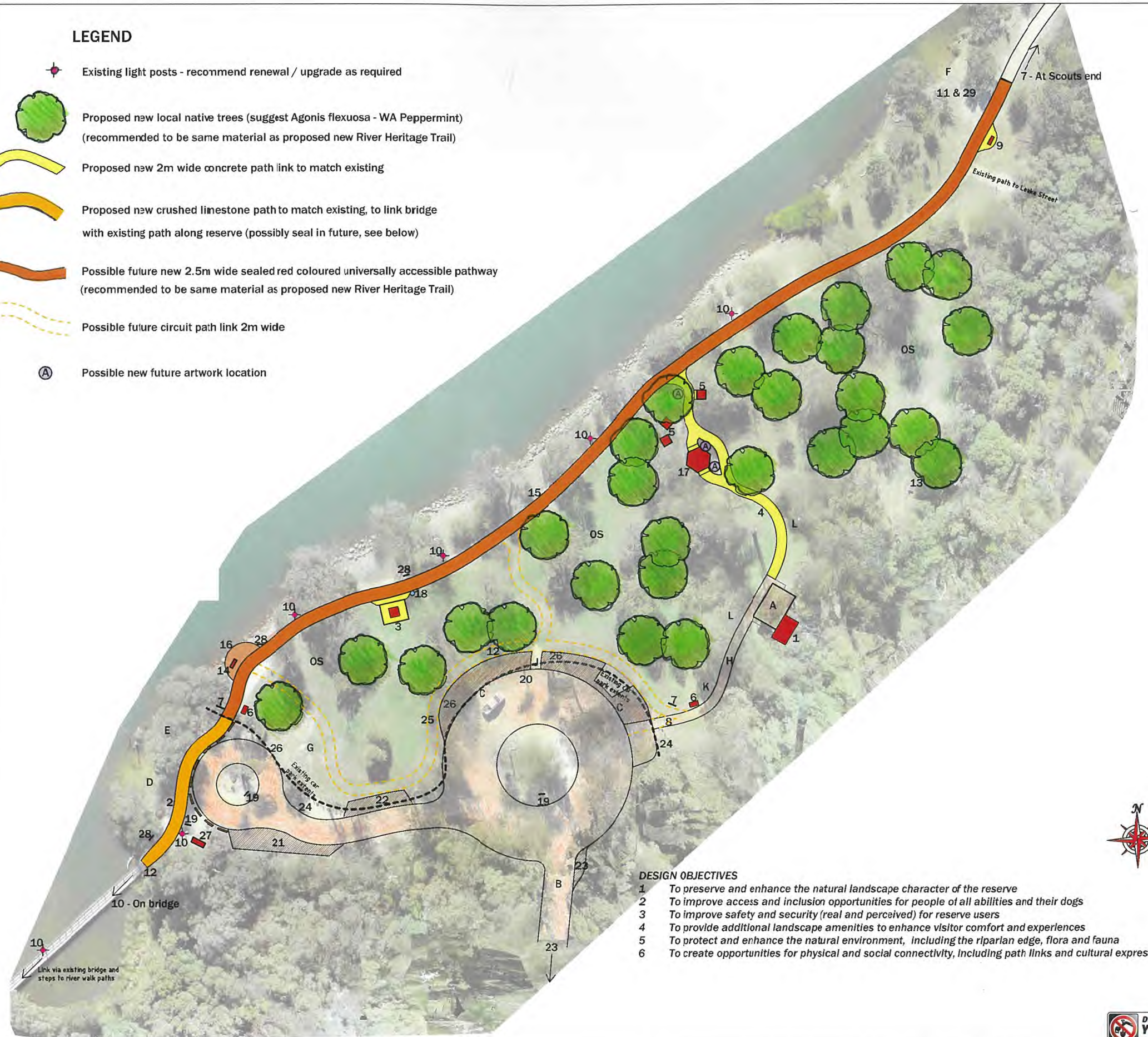

**DESIGN OBJECTIVES**

- 1 To preserve and enhance the natural landscape character of the reserve
- 2 To improve access and inclusion opportunities for people of all abilities and their dogs
- 3 To improve safety and security (real and perceived) for reserve users
- 4 To provide additional landscape amenities to enhance visitor comfort and experiences
- 5 To protect and enhance the natural environment, including the riparian edge, flora and fauna
- 6 To create opportunities for physical and social connectivity, including path links and cultural expression

AMENDMENT DESCRIPTION	BY	DATE	APPR	DESIGNED VP	DRAWN DATE 20/11/2018	SURVEYED	DRAWING TITLE WATSON RESERVE PRATT ROAD, EATON	ENGINEERING & DEVELOPMENT SERVICES	DRAWING NO. YEAR SHEET REVISION R25417-18-600-1-A	Shire of Dardanup Administration Centre Eaton P.O. Box 7017-1 Council Drive Eaton Western Australia 6232 ABN 57 305 829 653	Telephone 08 9724 0000 Facsimile 08 9724 0091 Online www.dardanup.wa.gov.au
				DRAWN VP	AUTHORISED LB	JOB NUMBER J11615	LANDSCAPE CONCEPT PLAN - DRAFT PROPOSED LANDSCAPE IMPROVEMENT WORKS PLAN FOR PUBLIC COMMENT - Not to standard scale				
GENERAL NOTES				NOTE				DATUM DATUM SHEET NO GRID SYSTEM GRID 4		A3	

